

FOREMAN 27



This two storey home is large and in charge. Upstairs you'll find the three bedrooms, including the commanding master, with generous ensuite and walk-in wardrobe. Downstairs though, is all about the shared spaces, with an expansive open-plan living area and generously appointed kitchen as well as a rear alfresco area. The Foreman is a knock out performer.

Dimensions

Fits 12.5m x 25m lots

Ground floor	109.50 m ²	11.79 sq
First floor	107.00 m ²	11.52 sq
Garage	36.19 m ²	3.90 sq
Porch	3.50 m ²	0.38 sq
Total	256.19 m ²	27.59 sq



Options

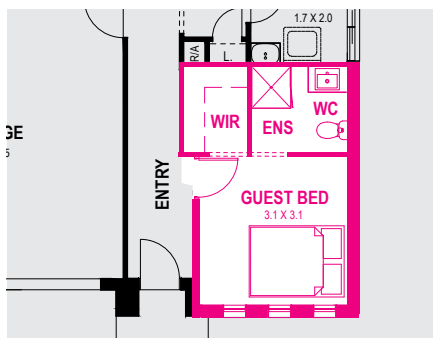

Guest bedroom option



Alfresco option